



CPLUS-V11SE2

UHD 4K 6G with HDCP2.2 Audio Extractor



4K2K
HDCP2.2

Operation Manual

DISCLAIMERS

The information in this manual has been carefully checked and is believed to be accurate. Cypress Technology assumes no responsibility for any infringements of patents or other rights of third parties which may result from its use.

Cypress Technology assumes no responsibility for any inaccuracies that may be contained in this document. Cypress also makes no commitment to update or to keep current the information contained in this document.

Cypress Technology reserves the right to make improvements to this document and/or product at any time and without notice.

COPYRIGHT NOTICE

No part of this document may be reproduced, transmitted, transcribed, stored in a retrieval system, or any of its part translated into any language or computer file, in any form or by any means—electronic, mechanical, magnetic, optical, chemical, manual, or otherwise—without express written permission and consent from Cypress Technology.

© Copyright 2015 by Cypress Technology.

All Rights Reserved.

TRADEMARK ACKNOWLEDGMENTS

All products or service names mentioned in this document may be trademarks of the companies with which they are associated.





SAFETY PRECAUTIONS

Please read all instructions before attempting to unpack, install or operate this equipment and before connecting the power supply.

Please keep the following in mind as you unpack and install this equipment:

- Always follow basic safety precautions to reduce the risk of fire, electrical shock and injury to persons.
- To prevent fire or shock hazard, do not expose the unit to rain, moisture or install this product near water.
- Never spill liquid of any kind on or into this product.
- Never push an object of any kind into this product through any openings or empty slots in the unit, as you may damage parts inside the unit.
- Do not attach the power supply cabling to building surfaces.
- Use only the supplied power supply unit (PSU). Do not use the PSU if it is damaged.
- Do not allow anything to rest on the power cabling or allow any weight to be placed upon it or any person walk on it.
- To protect the unit from overheating, do not block any vents or openings in the unit housing that provide ventilation and allow for sufficient space for air to circulate around the unit.

REVISION HISTORY

VERSION NO.	DATE (DD/MM/YY)	SUMMARY OF CHANGE
RDV1	26/08/15	Preliminary release



CONTENTS

1. Introduction	1
2. Applications	1
3. Package Contents	1
4. System Requirements	1
5. Features	2
6. Operation Controls and Functions	2
6.1 Front Panel	2
6.2 Rear Panel.....	3
7. Connection Diagram	4
8. Specifications	5
9. Acronyms	6





1. INTRODUCTION

The HDMI 4K 6G Audio Extractor could extract audio signals from your HDMI source. The unit allows you to extract original HDMI audio signal and convert it to digital optical or analog stereo L/R audio. Further, both input and output HDMI support UHD resolution up to 4K2K@60Hz (YUV444), and capable of provide high quality of audio and video performance. It supports HDMI high resolution digital audio formats by pass, also LPCM 2CH, Dolby TrueHD, Dolby Digital Plus, Dolby Atmos and DTS-HD Master Audio, audio sampling rate up to 192 kHz, allowing a full enjoyment over synchronize video and audio.

2. APPLICATIONS

- Game entertainment on monitor
- Audio Signal extended
- Audio extraction for non-HDMI AV receivers or wider audio systems

3. PACKAGE CONTENTS

- 1×UHD 4K 6G with HDCP2.2 Audio Extractor
- 1×5V/2.6A Power Adaptor
- 1×Operation Manual

4. SYSTEM REQUIREMENTS

Input source equipment such as Blu-ray/DVD player and output display HDMI UHD TV/monitor and amplifier/active speakers with connection cables.

Note: To achieve 6G performance will need to collocation with particular HDMI cable to get the better quality.

5. FEATURES

- HDMI2.0 with 4Kx2K 6G supported, HDCP 2.2 and DVI compliant
- Supports HDMI audio sampling rate up to 192 kHz
- Supports Optical S/PDIF audio sampling rate up to 192 kHz
- Supports external HDMI, Digital or Analog audio signal embeds into HDMI
- HDMI supports high-bit-rate (HBR) audio
- Supports DVI conversion with HDMI to DVI adaptor
- Supports CEC bypass
- Supports analog stereo L/R and Optical S/PDIF audio outputs
- Supports HDTV resolutions up to 4Kx2K (3840x2160@24/25/30/ 50/60 YUV_444 & 4096x2160@24/25/30/50/60 YUV_444).

Note: When displaying HDMI 4Kx2K signal, equivalent source signal, output display and HDMI cables are required in order to secure the best image display.

6. OPERATION CONTROLS AND FUNCTIONS

6.1 Front Panel

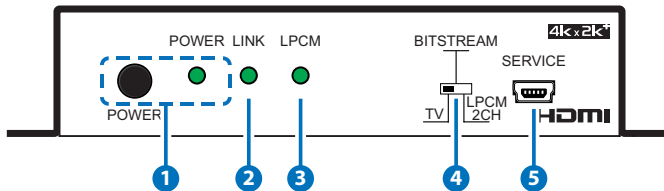

- 1 POWER & POWER LED:** Press POWER key to turn on/off the unit, when unit power on, the POWER LED will illuminated, turn off when unit power is disconnected.
- 2 LINK LED:** The LED will illuminate when detected HDMI input.
- 3 LPCM LED:** The LED will illuminate when detected LPCM Audio
- 4 TV/BITSTREAM & LPCM 2CH:** This allows users to switch audio signal from TV, Bitstream and LPCM 2CH.
- 5 SERVICE:** This for manufacture use only.

6.2 Rear Panel

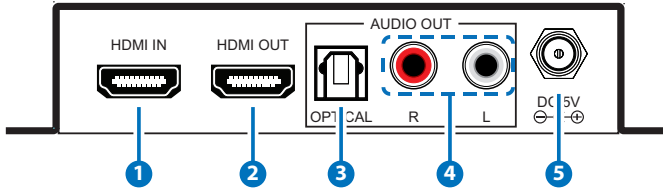

- 1 HDMI IN:** This slot is to connect with source equipment such as Blu-ray/PS3 player or PC/laptop with HDMI signal sending.
- 2 HDMI OUT:** Connect to HDMI UHD TV/display or UHD Amplifier for output image and or audio display.
- 3 OPTICAL AUDIO OUT:** Connect from audio equipment such as Amplifier or TV/display with optical signal input.
- 4 ANALOG AUDIO OUT:** Connect from audio equipment such as Amplifier or TV/display with L/R audio signal input.
- 5 DC 5V:** Connect the adaptor included in the package and connect to AC wall outlet for power supply.

7. CONNECTION DIAGRAM

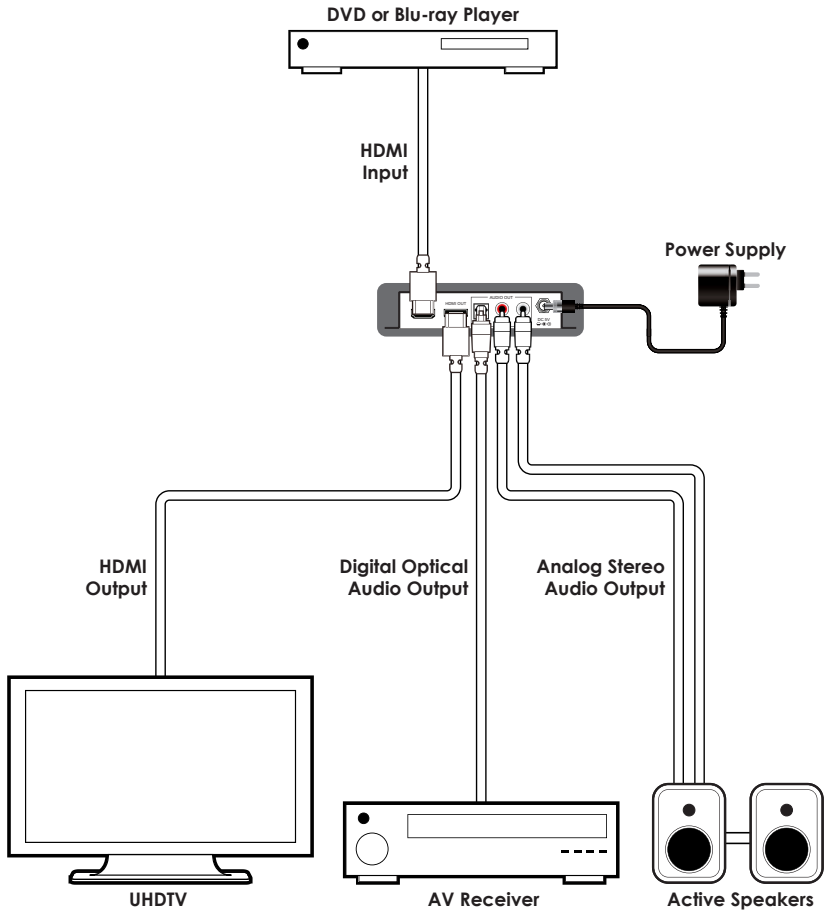



8. SPECIFICATIONS

Video Bandwidth	600 MHz/6 Gbps
Input Ports	1×HDMI, 1×Mini-USB (Service only)
Output Port	1×HDMI, 1×Optical, 2×RCA (Analog Audio)
HDMI Resolutions	VGA~WUXGA (RB), 408i~1080p@24/50/60, 4K@24/25/30, 4K@50/60 (YUV444)
HDMI Audio Sampling Rates	Up to 192 kHz
Optical Audio (S/PDIF) Sampling Rates	Up to 192 kHz
HDMI Audio Formats (Pass-through)	LPCM 2/5.1/7.1CH, Dolby Digital 2/5.1CH, DTS 2/5.1CH, Dolby Digital Plus, Dolby TrueHD, Dolby Atmos & DTS-HD Master Audio
Optical Audio Formats	LPCM 2CH, Dolby Digital 2/5.1CH & DTS 2/5.1CH
L/R Audio Format	Analog Stereo 2CH
HDMI Cable Distance	15 m@1080p/8-bit, 10 m@1080p/12-bit, 5 m@4K
Power Supply	5V/2.6A DC (US/EU standards, CE/FCC/UL certified)
ESD Protection	Human body model: ±8kV (air-gap discharge) ±4kV (contact discharge)
Dimensions	128 mm (W)×108 mm (D)×25 mm (H)/ Jack Excluded 128 mm (W)×116.8 mm (D)×30 mm (H)/ Jack Included
Weight	358 g
Chassis Material	Metal
Color	Black

Operating Temperature	0°C~40°C/32°F~104°F
Storage Temperature	-20°C~60°C/-4°F~140°F
Relative Humidity	20~90% RH (non-condensing)
Power Consumption	≈ W

Note: HDMI cable distance might be affected by material or design of cable.

9. ACRONYMS

ACRONYM	COMPLETE TERM
CEC	Consumer Electronics Control
COAX	Coaxial
DTS	Digital Theater System
DVI	Digital Visual Interface
HDCP	High-bandwidth Digital Content Protection
HDMI	High-Definition Multimedia Interface
HDTV	High-Definition Television
OPT	Optical
USB	Universal Serial Bus
VGA	Video Graphics Array
WUXGA (RB)	Widescreen Ultra Extended Graphics Array (Reduce Blanking)



CYPRESS TECHNOLOGY CO., LTD

Home page: <http://www.cypress.com.tw>